

UCHA200 Series

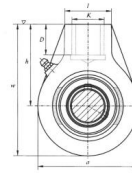
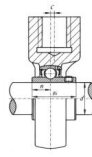

select	Inquiry	Bearing Unit No.	Shaft Dia(mm)		Dimensions [mm]										Bearing Housing No.	Weight(kg)
			in	mm	a	w	c	h	l	D	k	Bi	n			
UCHA201		12	64	96	0	64	40	19	G3/4	31	12.7	UC201	HA201	0.77		
UCHA201-8	1/2	12	64	96	0	64	40	19	G3/4	31	12.7	UC201-8	HA201	0.77		
UCHA202	5/8	15	64	96	0	64	40	19	G3/4	31	12.7	UC202	HA202	0.77		
UCHA202-10		15	64	96	0	64	40	19	G3/4	31	12.7	UC202-10	HA202	0.77		
UCHA203	11/16	17	64	96	0	64	40	19	G3/4	31	12.7	UC203	HA203	0.77		
UCHA203-11		17	64	96	0	64	40	19	G3/4	31	12.7	UC203-11	HA203	0.77		
UCHA204-12	3/4	20	64	96	0	64	40	19	G3/4	31	12.7	UC204-12	HA204	0.77		
UCHA204		20	64	96	0	64	40	19	G3/4	31	12.7	UC204	HA204	0.77		
UCHA205-14	7/8	25	78	103	0	64	40	19	G3/4	34	14.3	UC205-14	HA205	0.87		
UCHA205-15		25	78	103	0	64	40	19	G3/4	34	14.3	UC205-15	HA205	0.87		
UCHA205	15/16	25	78	103	0	64	40	19	G3/4	34	14.3	UC205	HA205	0.87		
UCHA205-16	1	25	78	103	0	64	40	19	G3/4	34	14.3	UC205-16	HA205	0.87		
UCHA206-18	1 1/8	30	78	103	0	64	40	19	G3/4	38.1	15.9	UC206-18	HA206	0.83		
UCHA206		30	78	103	0	64	40	19	G3/4	38.1	15.9	UC206	HA206	0.83		
UCHA206-19	1 3/16	30	78	103	0	64	40	19	G3/4	38.1	15.9	UC206-19	HA206	0.83		
UCHA206-20	1 1/4	30	78	103	0	64	40	19	G3/4	38.1	15.9	UC206-20	HA206	0.83		
UCHA207-20	1 1/4	35	92	116	0	70	40	19	G3/4	42.9	17.5	UC207-20	HA207	1.2		
UCHA207-21	1 5/16	35	92	116	0	70	40	19	G3/4	42.9	17.5	UC207-21	HA207	1.2		
UCHA207-22	1 3/8	35	92	116	0	70	40	19	G3/4	42.9	17.5	UC207-22	HA207	1.2		
UCHA207		35	92	116	0	70	40	19	G3/4	42.9	17.5	UC207	HA207	1.2		
UCHA207-23	1 3/16	35	92	116	0	70	40	19	G3/4	42.9	17.5	UC207-23	HA207	1.2		
UCHA208-24	1 1/2	40	96	121	2	73	40	19	G3/4	49.2	19	UC208-24	HA208	1.3		
UCHA208-25	1 9/16	40	96	121	2	73	40	19	G3/4	49.2	19	UC208-25	HA208	1.3		
UCHA208		40	96	121	2	73	40	19	G3/4	49.2	19	UC208	HA208	1.3		
UCHA209-26	1 5/8	45	108	136	5	82	48	21	G1	49.2	19	UC209-26	HA209	1.7		
UCHA209-27	1 11/16	45	108	136	5	82	48	21	G1	49.2	19	UC209-27	HA209	1.7		
UCHA209-28	1 3/4	45	108	136	5	82	48	21	G1	49.2	19	UC209-28	HA209	1.7		
UCHA209		45	108	136	5	82	48	21	G1	49.2	19	UC209	HA209	1.7		
UCHA210-30	1 7/8	50	118	142	5	83	48	21	G1	51.6	19	UC210-30	HA210	2.1		

UCHA200 Series

UCHA210-31	$\frac{1}{15/16}$	50	118	142	5	83	48	21	G1	51.6	19	UC210-31	HA210	2.1
------------	-------------------	----	-----	-----	---	----	----	----	----	------	----	----------	-------	-----