

UCT300 Series

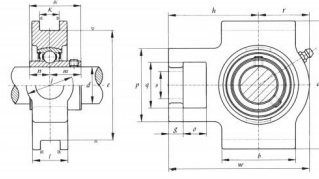

select	Inquiry	Bearing Unit No.	Shaft Dia		Dimensions [mm]																	Bearing No.	Housing No.	Weight(kg)
			in	mm	o	g	p	q	s	b	k	e	a	w	j	l	r	h	Bi	n	m			
UCT305		25	16	12	62	36	26	65	12	80	89	122	36	26	46	76	38	15	23	UCT305	T305	1.4		
UCT305-16	1	25	16	12	62	36	26	65	12	80	89	122	36	26	46	76	38	15	23	UCT305-16	T305	1.4		
UCT305-18	1 1/8	25	16	12	62	36	26	65	12	80	89	122	36	26	46	76	38	15	23	UCT305-18	T305	1.4		
UCT306		30	18	14	70	41	28	74	16	90	100	137	41	28	52	85	43	17	26	UCT306	T306	1.8		
UCT306-19	1 3/16	30	18	14	70	41	28	74	16	90	100	137	41	28	52	85	43	17	26	UCT306-19	T306	1.8		
UCT307-20	1 1/4	35	20	15	75	45	30	80	16	100	111	150	45	32	56	94	48	19	29	UCT307-20	T307	2.3		
UCT307-22	1 3/8	35	20	15	75	45	30	80	16	100	111	150	45	32	56	94	48	19	29	UCT307-22	T307	2.3		
UCT307		35	20	15	75	45	30	80	16	100	111	150	45	32	56	94	48	19	29	UCT307	T307	2.3		
UCT307-23	1 7/16	35	20	15	75	45	30	80	16	100	111	150	45	32	56	94	48	19	29	UCT307-23	T307	2.3		
UCT308-24	1 1/2	40	22	17	83	50	32	89	18	112	124	162	50	34	62	100	52	19	33	UCT308-24	T308	3		
UCT308		40	22	17	83	50	32	89	18	112	124	162	50	34	62	100	52	19	33	UCT308	T308	3		
UCT309-28	1 3/4	45	24	18	90	55	34	97	18	125	138	138	55	38	68	110	57	22	35	UCT309-28	T309	4.1		
UCT309		45	24	18	90	55	34	97	18	125	138	138	55	38	68	110	57	22	35	UCT309	T309	4.1		
UCT310-30	1 7/8	50	27	20	98	61	37	106	20	140	151	191	61	40	74	117	61	22	39	UCT310-30	T310	4.9		
UCT310-31	1 15/16	50	27	20	98	61	37	106	20	140	151	191	61	40	74	117	61	22	39	UCT310-31	T310	4.9		
UCT310		50	27	20	98	61	37	106	20	140	151	191	61	40	74	117	61	22	39	UCT310	T310	4.9		
UCT310-32	2	50	27	20	98	61	37	106	20	140	151	191	61	40	74	117	61	22	39	UCT310-32	T310	4.9		
UCT311-32	2	55	29	21	105	66	39	115	22	150	163	207	66	44	80	127	66	25	41	UCT311-32	T311	6.1		
UCT311		55	29	21	105	66	39	115	22	150	163	207	66	44	80	127	66	25	41	UCT311	T311	6.1		
UCT312		60	31	23	113	71	41	123	22	160	178	220	71	46	85	135	71	26	45	UCT312	T312	7.6		
UCT312-36	2 1/4	60	31	23	113	71	41	123	22	160	178	220	71	46	85	135	71	26	45	UCT312-36	T312	7.6		
UCT313-40	2 1/2	65	32	25	116	70	43	134	26	170	190	238	80	50	92	146	75	30	45	UCT313-40	T313	9.3		
UCT313		65	32	25	116	70	43	134	26	170	190	238	80	50	92	146	75	30	45	UCT313	T313	9.3		
UCT314-44	2 3/4	70	36	25	130	85	46	140	26	180	202	252	90	52	97	155	78	33	45	UCT314-44	T314	11.1		
UCT314		70	36	25	130	85	46	140	26	180	202	252	90	52	97	155	78	33	45	UCT314	T314	11.1		
UCT315		75	36	25	132	85	46	150	26	192	216	262	90	55	102	160	82	32	50	UCT315	T315	13		
UCT315-48	3	75	36	25	132	85	46	150	26	192	216	262	90	55	102	160	82	32	50	UCT315-48	T315	13		
UCT316		80	42	28	150	98	53	160	30	204	230	282	102	60	108	174	86	34	52	UCT316	T316	16.2		
UCT316-50	3 1/8	80	42	28	150	98	53	160	30	204	230	282	102	60	108	174	86	34	52	UCT316-50	T316	16.2		
UCT317		85	42	30	152	98	53	170	32	210	240	298	102	64	115	183	96	40	56	UCT317	T317	19		