

# UCST Series

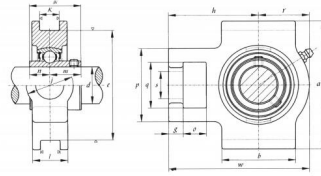

select	Inquiry	Bearing Unit No.	Shaft Dia in	Dimensions [mm]													Bi	n	Bearing Housing No.	Weight(kg)
				o	g	p	q	s	b	k	e	a	w	j	l	h				
UCST204-12	3/4	5/8	13/32	2	1 1/4	3/4	2	17/32	2 63/64	3 1/2	3 11/16	11/4	15/16	2 13/32	1.22	0.5	UC204-12	ST204	1.85	
UCST205-14	7/8	5/8	13/32	2	1 1/4	3/4	2	17/32	2 63/64	3 1/2	3 11/16	1 1/4	15/16	2 7/16	1.3386	0.563	UC205-14 205-15 205-16	ST205	1.78	
UCST205-15	15/16	5/8	13/32	2	1 1/4	3/4	2	17/32	2 63/64	3 1/2	3 11/16	1 1/4	15/16	2 7/16	1.3386	0.563	UC205-14 205-15 205-16	ST205	1.78	
UCST205-16	1	5/8	13/32	2	1 1/4	3/4	2	17/32	2 63/64	3 1/2	3 11/16	1 1/4	15/16	2 7/16	1.3386	0.563	UC205-14 205-15 205-16	ST205	1.78	
UCST206-17	1 1/16	5/8	13/32	2 7/32	1 15/32	55/64	2 1/4	17/32	3 1/2	4 1/32	4 7/16	1 15/32	1 3/32	2 3/4	1.5	0.626	UC206-17 206-18 206-19 206-20	ST206	2.42	
UCST206-18	1 1/8	5/8	13/32	2 7/32	1 15/32	55/64	2 1/4	17/32	3 1/2	4 1/32	4 7/16	1 15/32	1 3/32	2 3/4	1.5	0.626	UC206-17 206-18 206-19 206-20	ST206	2.42	
UCST206-19	1 3/16	5/8	13/32	2 7/32	1 15/32	55/64	2 1/4	17/32	3 1/2	4 1/32	4 7/16	1 15/32	1 3/32	2 3/4	1.5	0.626	UC206-17 206-18 206-19 206-20	ST206	2.42	
UCST206-20	1 1/4	5/8	13/32	2 7/32	1 15/32	55/64	2 1/4	17/32	3 1/2	4 1/32	4 7/16	1 15/32	1 3/32	2 3/4	1.5	0.626	UC206-17 206-18 206-19 206-20	ST206	2.42	
UCST207-20	1 1/4	5/8	1/2	2 17/32	1 15/32	55/64	2 17/32	17/32	3 1/2	4 1/32	5 3/32	1 15/32	1 3/16	3 1/16	1.689	0.689	UC207-20 207-21 207-22 207-23	ST207	3.53	
UCST207-21	1 5/16	5/8	1/2	2 17/32	1 15/32	55/64	2 17/32	17/32	3 1/2	4 1/32	5 3/32	1 15/32	1 3/16	3 1/16	1.689	0.689	UC207-20 207-21 207-22 207-23	ST207	3.53	
UCST207-22	1 3/8	5/8	1/2	2 17/32	1 15/32	55/64	2 17/32	17/32	3 1/2	4 1/32	5 3/32	1 15/32	1 3/16	3 1/16	1.689	0.689	UC207-20 207-21 207-22 207-23	ST207	3.53	
UCST207-23	1 7/16	5/8	1/2	2 17/32	1 15/32	55/64	2 17/32	17/32	3 1/2	4 1/32	5 3/32	1 15/32	1 3/16	3 1/16	1.689	0.689	UC207-20 207-21 207-22 207-23	ST207	3.53	
UCST208-24	1 1/2	3/4	5/8	3 9/32	1 15/32	1 9/64	3 9/32	11/16	4 1/64	4 1/2	5 21/32	1 5/16	1 5/16	3 15/32	1.937	0.748	UC208-24	ST208	5.3	
UCST208-25	1 9/16	3/4	5/8	3 9/32	1 15/32	1 9/64	3 9/32	11/16	4 1/64	4 1/2	5 21/32	1 5/16	1 5/16	3 15/32	1.937	0.748	UC208-24	ST208	5.3	
UCST209-26	1 5/8	3/4	5/8	3 9/32	1 15/16	1 9/64	3 9/32	11/16	41/64	4 19/32	5 21/32	1 15/16	1 3/8	3 7/16	1.937	0.748	UC209-26 209-27 209-28	ST209	5.3	
UCST209-27	1 11/16	3/4	5/8	3 9/32	1 15/16	1 9/64	3 9/32	11/16	41/64	4 19/32	5 21/32	1 15/16	1 3/8	3 7/16	1.937	0.748	UC209-26 209-27 209-28	ST209	5.3	
UCST209-28	1 3/4	3/4	5/8	3 9/32	1 15/16	1 9/64	3 9/32	11/16	41/64	4 19/32	5 21/32	1 15/16	1 3/8	3 7/16	1.937	0.748	UC209-26 209-27 209-28	ST209	5.3	
UCST210-30	1 7/8	3/4	5/8	3 9/32	1 15/16	1 9/64	3 3/8	11/16	4 1/64	4 19/32	5 7/8	1 15/16	1 15/32	3 17/32	2.031	0.748	UC210-30 210-31 210-32	ST210	5.4	
UCST210-31	1 15/16	3/4	5/8	3 9/32	1 15/16	1 9/64	3 3/8	11/16	4 1/64	4 19/32	5 7/8	1 15/16	1 15/32	3 17/32	2.031	0.748	UC210-30 210-31 210-32	ST210	5.4	
UCST210-32	2	3/4	5/8	3 9/32	1 15/16	1 9/64	3 3/8	11/16	4 1/64	4 19/32	5 7/8	1 15/16	1 15/32	3 17/32	2.031	0.748	UC210-30 210-31 210-32	ST210	5.4	
UCST211-32	2	1	3/4	4 1/32	2 17/32	1 3/8	3 3/4	1 1/16	5 1/8	5 3/4	6 23/32	2 17/32	1 1/2	4 3/16	2.189	0.874	UC211-32 211-34 211-35	ST211	9.04	
UCST211-34	2 1/8	1	3/4	4 1/32	2 17/32	1 3/8	3 3/4	1 1/16	5 1/8	5 3/4	6 23/32	2 17/32	1 1/2	4 3/16	2.189	0.874	UC211-32 211-34 211-35	ST211	9.04	

## UCST Series

UCST211-35	$\frac{2}{3/16}$	1	$\frac{3}{4}$	$\frac{4}{1/32}$	$\frac{2}{17/32}$	$\frac{1}{3/8}$	$\frac{3}{3/4}$	$\frac{1}{1/16}$	$\frac{5}{1/8}$	$\frac{5}{3/4}$	$\frac{6}{23/32}$	$\frac{2}{17/32}$	$\frac{1}{1/2}$	$\frac{4}{3/16}$	2.189	0.874	UC211-32 211-34 211-35	ST211	9.04
UCST212-36	$\frac{2}{1/4}$	$\frac{1}{1/4}$	$\frac{3}{4}$	$\frac{4}{1/32}$	$\frac{2}{17/32}$	$\frac{1}{3/8}$	$\frac{4}{1/32}$	$\frac{1}{1/16}$	$\frac{5}{1/8}$	$\frac{5}{3/4}$	$\frac{7}{5/8}$	$\frac{2}{17/32}$	$\frac{1}{21/32}$	$\frac{4}{11/16}$	2.563	1	UC212-36 212-38 212-39	ST212	11
UCST212-38	$\frac{2}{3/8}$	$\frac{1}{1/4}$	$\frac{3}{4}$	$\frac{4}{1/32}$	$\frac{2}{17/32}$	$\frac{1}{3/8}$	$\frac{4}{1/32}$	$\frac{1}{1/16}$	$\frac{5}{1/8}$	$\frac{5}{3/4}$	$\frac{7}{5/8}$	$\frac{2}{17/32}$	$\frac{1}{21/32}$	$\frac{4}{11/16}$	2.563	1	UC212-36 212-38 212-39	ST212	11
UCST212-39	$\frac{2}{7/16}$	$\frac{1}{1/4}$	$\frac{3}{4}$	$\frac{4}{1/32}$	$\frac{2}{17/32}$	$\frac{1}{3/8}$	$\frac{4}{1/32}$	$\frac{1}{1/16}$	$\frac{5}{1/8}$	$\frac{5}{3/4}$	$\frac{7}{5/8}$	$\frac{2}{17/32}$	$\frac{1}{21/32}$	$\frac{4}{11/16}$	2.563	1	UC212-36 212-38 212-39	ST212	11
UCST213-40	$\frac{2}{1/2}$	$\frac{1}{1/4}$	$\frac{13}{16}$	$\frac{4}{3/8}$	$\frac{2}{3/4}$	$\frac{1}{39/64}$	$\frac{4}{3/4}$	$\frac{1}{1/16}$	$\frac{5}{15/16}$	$\frac{6}{9/16}$	$\frac{8}{13/16}$	$\frac{2}{3/4}$	$\frac{1}{23/32}$	$\frac{5}{13/32}$	2.563	1	UC213-40	ST213	15.5