

UCPX00 Series

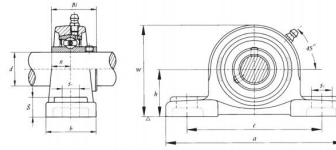

select	Inquiry	Bearing Unit No.	Shaft Dia(d)		Dimensions [mm]											Bolt Dimensions		Bearing Housing No.	Weight(kg)
			in	mm	h	a	e	b	s2	s1	g	w	Bi	n	mm	in			
UCPX05		25	44.4	159	119	51	25	17	18	85	38.1	15.9	M14	1/2	UCPX05	PX05	1.5		
UCPX05-14	7/8	25	44.4	159	119	51	25	17	18	85	38.1	15.9	M14	1/2	UCPX05-14	PX05	1.5		
UCPX05-16	1	25	44.4	159	119	51	25	17	18	85	38.1	15.9	M14	1/2	UCPX05-16	PX05	1.5		
UCPX06		30	47.6	175	127	57	25	17	20	94	42.9	17.5	M14	1/2	UCPX06	PX06	2		
UCPX06-18	1 1/8	30	47.6	175	127	57	25	17	20	94	42.9	17.5	M14	1/2	UCPX06-18	PX06	2		
UCPX06-19	1 3/16	30	47.6	175	127	57	25	17	20	94	42.9	17.5	M14	1/2	UCPX06-19	PX06	2		
UCPX06-20	1 1/4	30	47.6	175	127	57	25	17	20	94	42.9	17.5	M14	1/2	UCPX06-20	PX06	2		
UCPX07		35	54	203	144	57	30	17	22	105	49.2	19	M14	1/2	UCPX07	PX07	2.7		
UCPX07-20	1 1/4	35	54	203	144	57	30	17	22	105	49.2	19	M14	1/2	UCPX07-20	PX07	2.7		
UCPX07-22	1 3/8	35	54	203	144	57	30	17	22	105	49.2	19	M14	1/2	UCPX07-22	PX07	2.7		
UCPX07-23	1 7/16	35	54	203	144	57	30	17	22	105	49.2	19	M14	1/2	UCPX07-23	PX07	2.7		
UCPX08		40	58.7	222	156	67	32	20	26	113	49.2	19	M16	5/8	UCPX08	PX08	3.5		
UCPX08-24	1 1/2	40	58.7	222	156	67	32	20	26	113	49.2	19	M16	5/8	UCPX08-24	PX08	3.5		
UCPX09		45	58.7	222	156	67	33	20	26	116	51.6	19	M16	5/8	UCPX09	PX09	3.6		
UCPX09-26	1 5/8	45	58.7	222	156	67	33	20	26	116	51.6	19	M16	5/8	UCPX09-26	PX09	3.6		
UCPX09-27	1 11/16	45	58.7	222	156	67	33	20	26	116	51.6	19	M16	5/8	UCPX09-27	PX09	3.6		
UCPX09-28	1 3/4	45	58.7	222	156	67	33	20	26	116	51.6	19	M16	5/8	UCPX09-28	PX09	3.6		
UCPX10		50	63.5	241	171	73	36	20	27	126	55.6	22.2	M16	5/8	UCPX10	PX10	4.4		
UCPX10-31	1 15/16	50	63.5	241	171	73	36	20	27	126	55.6	22.2	M16	5/8	UCPX10-31	PX10	4.4		
UCPX10-32	2	50	63.5	241	171	73	36	20	27	126	55.6	22.2	M16	5/8	UCPX10-32	PX10	4.4		
UCPX11		55	69.8	260	184	79	36	25	30	139	65.1	25.4	M20	3/4	UCPX11	PX11	6.3		
UCPX11-32	2	55	69.8	260	184	79	36	25	30	139	65.1	25.4	M20	3/4	UCPX11-32	PX11	6.3		
UCPX11-35	2 3/16	55	69.8	260	184	79	36	25	30	139	65.1	25.4	M20	3/4	UCPX11-35	PX11	6.3		
UCPX11-36	2 1/4	55	69.8	260	184	79	36	25	30	139	65.1	25.4	M20	3/4	UCPX11-36	PX11	6.3		
UCPX12		60	76.2	286	203	83	41	25	32	152	65.1	25.4	M20	3/4	UCPX12	PX12	7.4		
UCPX12-36	2 1/4	60	76.2	286	203	83	41	25	32	152	65.1	25.4	M20	3/4	UCPX12-36	PX12	7.4		
UCPX12-38	2 3/8	60	76.2	286	203	83	41	25	32	152	65.1	25.4	M20	3/4	UCPX12-38	PX12	7.4		
UCPX12-39	2 7/16	60	76.2	286	203	83	41	25	32	152	65.1	25.4	M20	3/4	UCPX12-39	PX12	7.4		
UCPX13		65	76.2	286	203	83	41	25	32	154	74.6	30.2	M20	3/4	UCPX13	PX13	7.7		
UCPX13-40	2 1/2	65	76.2	286	203	83	41	25	32	154	74.6	30.2	M20	3/4	UCPX13-40	PX13	7.7		