

# UCT200 Series

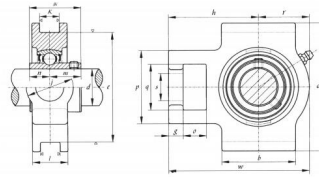
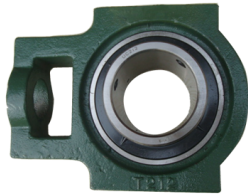

| select | Inquiry | Bearing Shaft |     | Dimensions [mm] |    |    |     |    |     |     |     |    |    |     |      |      |       | Bearing Housing |       | Weight(kg) |
|--------|---------|---------------|-----|-----------------|----|----|-----|----|-----|-----|-----|----|----|-----|------|------|-------|-----------------|-------|------------|
|        |         | Unit No.      | Dia | o               | g  | p  | q   | s  | b   | k   | e   | a  | w  | j   | l    | h    | Bi    | n               | No.   |            |
| UCT201 | 12      | 16            | 10  | 51              | 32 | 19 | 51  | 12 | 76  | 89  | 94  | 32 | 21 | 61  | 31   | 12.7 | UC201 | T204            | 0.75  |            |
| UCT202 | 15      | 16            | 10  | 51              | 32 | 19 | 51  | 12 | 76  | 89  | 94  | 32 | 21 | 61  | 31   | 12.7 | UC202 | T204            | 0.73  |            |
| UCT203 | 17      | 16            | 10  | 51              | 32 | 19 | 51  | 12 | 76  | 89  | 94  | 32 | 21 | 61  | 31   | 12.7 | UC203 | T204            | 0.72  |            |
| UCT204 | 20      | 16            | 10  | 51              | 32 | 19 | 51  | 12 | 76  | 89  | 94  | 32 | 21 | 61  | 31   | 12.7 | UC204 | T204            | 0.7   |            |
| UCT205 | 25      | 16            | 10  | 51              | 32 | 19 | 51  | 12 | 76  | 89  | 97  | 32 | 24 | 62  | 34   | 14.3 | UC205 | T205            | 0.73  |            |
| UCT206 | 30      | 16            | 10  | 56              | 37 | 22 | 57  | 12 | 89  | 102 | 113 | 37 | 28 | 70  | 38.1 | 15.9 | UC206 | T206            | 1.17  |            |
| UCT207 | 35      | 16            | 13  | 64              | 37 | 22 | 64  | 12 | 89  | 102 | 129 | 37 | 30 | 78  | 42.9 | 17.5 | UC207 | T207            | 1.45  |            |
| UCT208 | 40      | 19            | 16  | 83              | 49 | 29 | 83  | 16 | 102 | 114 | 144 | 49 | 33 | 88  | 49.2 | 19   | UC208 | T208            | 2.11  |            |
| UCT209 | 45      | 19            | 16  | 83              | 49 | 29 | 83  | 16 | 102 | 117 | 144 | 49 | 35 | 87  | 49.2 | 19   | UC209 | T209            | 2.18  |            |
| UCT210 | 50      | 19            | 16  | 83              | 49 | 29 | 86  | 16 | 102 | 117 | 149 | 49 | 37 | 90  | 51.6 | 19   | UC210 | T210            | 2.35  |            |
| UCT211 | 55      | 25            | 19  | 102             | 64 | 35 | 95  | 22 | 130 | 146 | 171 | 64 | 38 | 106 | 55.6 | 22.2 | UC211 | T211            | 3.56  |            |
| UCT212 | 60      | 32            | 19  | 102             | 64 | 35 | 102 | 22 | 130 | 146 | 194 | 64 | 42 | 119 | 65.1 | 25.4 | UC212 | T212            | 4.23  |            |
| UCT213 | 65      | 32            | 21  | 111             | 70 | 41 | 121 | 26 | 151 | 167 | 224 | 70 | 44 | 137 | 65.1 | 25.4 | UC213 | T213            | 6.04  |            |
| UCT214 | 70      | 32            | 21  | 111             | 70 | 41 | 121 | 26 | 151 | 167 | 224 | 70 | 46 | 137 | 74.6 | 30.2 | UC214 | T214            | 6.35  |            |
| UCT215 | 75      | 32            | 21  | 111             | 70 | 41 | 121 | 26 | 151 | 167 | 232 | 70 | 48 | 140 | 77.8 | 33.3 | UC215 | T215            | 6.6   |            |
| UCT216 | 80      | 32            | 21  | 111             | 70 | 41 | 121 | 26 | 165 | 184 | 235 | 70 | 51 | 140 | 82.6 | 33.3 | UC216 | T216            | 7.24  |            |
| UCT217 | 85      | 38            | 29  | 124             | 73 | 48 | 157 | 30 | 173 | 198 | 260 | 73 | 54 | 162 | 85.7 | 34.1 | UC217 | T217            | 10.33 |            |