

UCFL Series

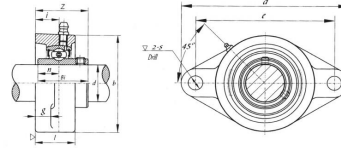

select	Inquiry	Bearing Unit No.	Shaft Dia(mm)		Dimensions(mm)										Bolt Used		Bearing Housing Weight(kg)	
			in	mm	a	e	i	g	l	s	b	z	Bi	n	mm	in	No.	No.
UCFL201		12	113	90	15	11	25.5	12	60	33.3	31	12.7	M10	3/8	UCFL201	FL201	0.44	
UCFL201-8	1/2	12	113	90	15	11	25.5	12	60	33.3	31	12.7	M10	3/8	UCFL201-8	FL201	0.44	
UCFL202		15	113	90	15	11	25.5	12	60	33.3	31	12.7	M10	3/8	UCFL202	FL202	0.42	
UCFL202-10	5/8	15	113	90	15	11	25.5	12	60	33.3	31	12.7	M10	3/8	UCFL202-10	FL202	0.42	
UCFL203		17	113	90	15	11	25.5	12	60	33.3	31	12.7	M10	3/8	UCFL203	FL203	0.41	
UCFL203-11	11/16	17	113	90	15	11	25.5	12	60	33.3	31	12.7	M10	3/8	UCFL203-11	FL203	0.41	
UCFL204		20	113	90	15	11	25.5	12	60	33.3	31	12.7	M10	3/8	UCFL204	FL204	0.39	
UCFL204-12	3/4	20	113	90	15	11	25.5	12	60	33.3	31	12.7	M10	3/8	UCFL204-12	FL204	0.39	
UCFL205		25	130	99	16	13	27	16	68	35.7	34.1	14.3	M14	1/2	UCFL205	FL205	0.57	
UCFL205-14	7/8	25	130	99	16	13	27	16	68	35.7	34.1	14.3	M14	1/2	UCFL205-14	FL205	0.57	
UCFL205-15	15/16	25	130	99	16	13	27	16	68	35.7	34.1	14.3	M14	1/2	UCFL205-15	FL205	0.57	
UCFL205-16	1	25	130	99	16	13	27	16	68	35.7	34.1	14.3	M14	1/2	UCFL205-16	FL205	0.57	
UCFL206		30	148	117	18	13	31	16	80	40.2	38.1	15.9	M14	1/2	UCFL206	FL206	0.76	
UCFL206-18	1 1/8	30	148	117	18	13	31	16	80	40.2	38.1	15.9	M14	1/2	UCFL206-18	FL206	0.76	
UCFL206-19	1 3/16	30	148	117	18	13	31	16	80	40.2	38.1	15.9	M14	1/2	UCFL206-19	FL206	0.76	
UCFL206-20	1 1/4	30	148	117	18	13	31	16	80	40.2	38.1	15.9	M14	1/2	UCFL206-20	FL206	0.76	
UCFL207		35	161	130	19	14	34	16	90	44.4	42.9	17.5	M14	1/2	UCFL207	FL207	1.05	
UCFL207-20	1 1/4	35	161	130	19	14	34	16	90	44.4	42.9	17.5	M14	1/2	UCFL207-20	FL207	1.05	
UCFL207-21	1 5/16	35	161	130	19	14	34	16	90	44.4	42.9	17.5	M14	1/2	UCFL207-21	FL207	1.05	
UCFL207-22	1 3/8	35	161	130	19	14	34	16	90	44.4	42.9	17.5	M14	1/2	UCFL207-22	FL207	1.05	
UCFL207-23	1 7/16	35	161	130	19	14	34	16	90	44.4	42.9	17.5	M14	1/2	UCFL207-23	FL207	1.05	
UCFL208		40	175	144	21	14	36	16	100	51.2	49.2	19	M14	1/2	UCFL208	FL208	1.34	
UCFL208-24	1/2	40	175	144	21	14	36	16	100	51.2	49.2	19	M14	1/2	UCFL208-24	FL208	1.34	
UCFL208-25	1 9/16	40	175	144	21	14	36	16	100	51.2	49.2	19	M14	1/2	UCFL208-25	FL208	1.34	
UCFL209		45	188	148	22	15	38	19	108	52.2	49.2	19	M16	5/8	UCFL209	FL209	1.7	
UCFL209-26	1 5/8	45	188	148	22	15	38	19	108	52.2	49.2	19	M16	5/8	UCFL209-26	FL209	1.7	
UCFL209-27	1 11/16	45	188	148	22	15	38	19	108	52.2	49.2	19	M16	5/8	UCFL209-27	FL209	1.7	
UCFL209-28	1 3/4	45	188	148	22	15	38	19	108	52.2	49.2	19	M16	5/8	UCFL209-28	FL209	1.7	
UCFL210		50	197	157	22	15	40	19	115	54.6	51.6	19	M16	5/8	UCFL210	FL210	1.92	
UCFL210-30	1 7/8	50	197	157	22	15	40	19	115	54.6	51.6	19	M16	5/8	UCFL210-30	FL210	1.92	