

# UCPH200 系列

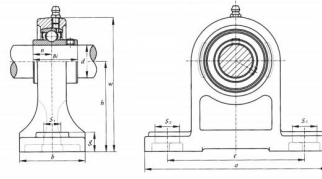

select	Inquiry	轴承 型号	轴径		尺寸□mm□										螺栓尺寸		轴承 型号	重量 (g)
			in	mm	h	a	e	b	s2	s1	g	w	Bi	n	mm	in		
UCPH201		12	70	127	95	40	19	13	15	101	31	12.7	M10	3/8	UCPH201	PH201	0.96	
UCPH201-8	1/2	12	70	127	95	40	19	13	15	101	31	12.7	M10	3/8	UCPH201-8	PH201	0.96	
UCPH202		15	70	127	95	40	19	13	15	101	31	12.7	M10	3/8	UCPH202	PH202	0.96	
UCPH202-10	5/8	15	70	127	95	40	19	13	15	101	31	12.7	M10	3/8	UCPH202-10	PH202	0.96	
UCPH203		17	70	127	95	40	19	13	15	101	31	12.7	M10	3/8	UCPH203	PH203	0.96	
UCPH203-11	11/16	17	70	127	95	40	19	13	15	101	31	12.7	M10	3/8	UCPH203-11	PH203	0.96	
UCPH204-12	3/4	20	70	127	95	40	19	13	15	101	31	12.7	M10	3/8	UCPH204-12	PH204	0.96	
UCPH204		20	70	127	95	40	19	13	15	101	31	12.7	M10	3/8	UCPH204	PH204	0.96	
UCPH205-14	7/8	25	80	140	105	50	19	13	16	114	34.1	14.3	M10	3/8	UCPH205-14	PH205	1.2	
UCPH205-15	15/16	25	80	140	105	50	19	13	16	114	34.1	14.3	M10	3/8	UCPH205-15	PH205	1.2	
UCPH205		25	80	140	105	50	19	13	16	114	34.1	14.3	M10	3/8	UCPH205	PH205	1.2	
UCPH205-16	1	25	80	140	105	50	19	13	16	114	34.1	14.3	M10	3/8	UCPH205-16	PH205	1.2	
UCPH206-18	1 1/8	30	90	165	121	50	21	17	18	130	38.1	15.9	M14	1/2	UCPH206-18	PH206	1.6	
UCPH206-19	1 3/16	30	90	165	121	50	21	17	18	130	38.1	15.9	M14	1/2	UCPH206-19	PH206	1.6	
UCPH206		30	90	165	121	50	21	17	18	130	38.1	15.9	M14	1/2	UCPH206	PH206	1.6	
UCPH206-20	1 1/4	30	90	165	121	50	21	17	18	130	38.1	15.9	M14	1/2	UCPH206-20	PH206	1.6	
UCPH207-20	1 1/4	35	95	167	127	60	21	17	18	140	42.9	17.5	M14	1/2	UCPH207-20	PH207	2	
UCPH207-21	1 5/16	35	95	167	127	60	21	17	18	140	42.9	17.5	M14	1/2	UCPH207-21	PH207	2	
UCPH207-22	1 3/8	35	95	167	127	60	21	17	18	140	42.9	17.5	M14	1/2	UCPH207-22	PH207	2	
UCPH207		35	95	167	127	60	21	17	18	140	42.9	17.5	M14	1/2	UCPH207	PH207	2	
UCPH207-23	1 7/16	35	95	167	127	60	21	17	18	140	42.9	17.5	M14	1/2	UCPH207-23	PH207	2	
UCPH208-24	1 1/2	40	100	184	137	70	21	17	20	150	49.2	19	M14	1/2	UCPH208-24	PH208	2.7	
UCPH208-25	1 9/16	40	100	184	137	70	21	17	20	150	49.2	19	M14	1/2	UCPH208-25	PH208	2.7	
UCPH208		40	100	184	137	70	21	17	20	150	49.2	19	M14	1/2	UCPH208	PH208	2.7	
UCPH209-26	1 5/8	45	105	190	146	70	21	17	20	158	49.2	19	M14	1/2	UCPH209-26	PH209	3	
UCPH209-27	1 11/16	45	105	190	146	70	21	17	20	158	49.2	19	M14	1/2	UCPH209-27	PH209	3	
UCPH209-28	1 3/4	45	105	190	146	70	21	17	20	158	49.2	19	M14	1/2	UCPH209-28	PH209	3	
UCPH209		45	105	190	146	70	21	17	20	158	49.2	19	M14	1/2	UCPH209	PH209	3	

## UCPH200 系列

UCPH210-30	1 7/8	50	110	206	159	70	22	20	22	165	51.6	19	M16	5/8	UCPH210-30	PH210	3.5
UCPH210-31	1 15/16	50	110	206	159	70	22	20	22	165	51.6	19	M16	5/8	UCPH210-31	PH210	3.5