

UCP300 系列

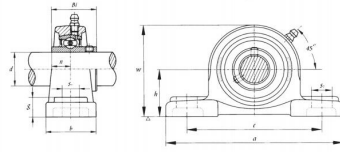

select	Inquiry	轴承 型号	轴径(d)		尺寸□mm□										螺栓尺寸		轴承型 号	轴承座 重量(kg)
			in	mm	h	a	e	b	s2	s1	g	w	Bi	n	mm	in		
UCP305		25	45	175	132	45	20	17	16	85	38	15	M14	1/2	UCP305	P305	1.28	
UCP305-14	7/8	25	45	175	132	45	20	17	16	85	38	15	M14	1/2	UCP305-14	P305	1.28	
UCP305-16	1	25	45	175	132	45	20	17	16	85	38	15	M14	1/2	UCP305-16	P305	1.28	
UCP306		30	50	180	140	50	20	17	18	95	43	17	M14	1/2	UCP306	P306	1.72	
UCP306-18	1 1/8	30	50	180	140	50	20	17	18	95	43	17	M14	1/2	UCP306-18	P306	1.72	
UCP306-19	1 3/16	30	50	180	140	50	20	17	18	95	43	17	M14	1/2	UCP306-19	P306	1.72	
UCP307		35	56	210	160	56	25	17	20	106	48	19	M14	1/2	UCP307	P307	2.33	
UCP307-20	1 1/4	35	56	210	160	56	25	17	20	106	48	19	M14	1/2	UCP307-20	P307	2.33	
UCP307-21	1 3/8	35	56	210	160	56	25	17	20	106	48	19	M14	1/2	UCP307-21	P307	2.33	
UCP307-23	1 7/16	35	56	210	160	56	25	17	20	106	48	19	M14	1/2	UCP307-23	P307	2.33	
UCP308		40	60	220	170	60	27	17	22	116	52	19	M14	1/2	UCP308	P308	3.01	
UCP308-24	1 1/2	40	60	220	170	60	27	17	22	116	52	19	M14	1/2	UCP308-24	P308	3.01	
UCP309		45	67	245	190	67	30	20	24	129	57	22	M16	5/8	UCP309	P309	3.77	
UCP309-28	1 3/4	45	67	245	190	67	30	20	24	129	57	22	M16	5/8	UCP309-28	P309	3.77	
UCP310		50	75	275	212	75	35	20	27	143	61	22	M16	5/8	UCP310	P310	5.47	
UCP310-31	1 15/16	50	75	275	212	75	35	20	27	143	61	22	M16	5/8	UCP310-31	P310	5.47	
UCP311		55	80	310	236	80	38	20	30	154	66	25	M16	5/8	UCP311	P311	6.83	
UCP311-32	2	55	80	310	236	80	38	20	30	154	66	25	M16	5/8	UCP311-32	P311	6.83	
UCP312		60	85	330	250	85	38	25	32	165	71	26	M20	3/4	UCP312	P312	8.15	
UCP312-36	2 1/4	60	85	330	250	85	38	25	32	165	71	26	M20	3/4	UCP312-36	P312	8.15	
UCP313		65	90	340	260	90	38	25	35	176	75	30	M20	3/4	UCP313	P313	9.41	
UCP313-40	2 1/2	65	90	340	260	90	38	25	35	176	75	30	M20	3/4	UCP313-40	P313	9.41	
UCP314		70	95	360	280	90	40	27	35	187	78	33	M22	7/8	UCP314	P314	11.08	
UCP314-44	2 3/4	70	95	360	280	90	40	27	35	187	78	33	M22	7/8	UCP314-44	P314	11.08	
UCP315		75	100	380	290	100	40	27	35	198	82	32	M22	7/8	UCP315	P315	13.8	
UCP315-47	2 15/16	75	100	380	290	100	40	27	35	198	82	32	M22	7/8	UCP315-47	P315	13.8	
UCP315-48	3	75	100	380	290	100	40	27	35	198	82	32	M22	7/8	UCP315-48	P315	13.8	
UCP316		80	106	400	300	110	40	27	40	210	86	34	M22	7/8	UCP316	P316	16.2	

UCP300 系列

UCP316-50	3 1/8	80	106	400	300	110	40	27	40	210	86	34	M22	7/8	UCP316-50	P316	16.2
UCP317		85	112	420	320	110	45	33	40	220	96	40	M27	1	UCP317	P317	19.2