

# UCFC 系列

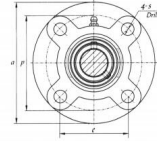
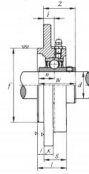

select	Inquiry	轴承 型号	轴径		尺寸□mm□													螺栓尺寸		轴承 型号	重量 kg
			in	mm	a	p	e	i	l	s	j	k	g	f	z	Bi	n	mm	in		
UCFC201		12	100	78	55.116	10	25.5	12	5	7	20.5	62	28.3	31	12.7	M10	3/8	UCFC201	FC201	0.71	
UCFX201-8	1/2	12	100	78	55.116	10	25.5	12	5	7	20.5	62	28.3	31	12.7	M10	3/8	UCFX201-8	FC201	0.71	
UCFC202		15	100	78	55.1	10	25.5	12	5	7	20.5	62	28.3	31	12.7	M10	3/8	UCFC202	FC202	0.69	
UCFX202-10	5/8	15	100	78	55.1	10	25.5	12	5	7	20.5	62	28.3	31	12.7	M10	3/8	UCFX202-10	FC202	0.69	
UCFC203		17	100	78	55.1	10	25.5	12	6	7	20.5	62	28.3	31	12.7	M10	3/8	UCFC203	FC203	0.68	
UCFX203-11	11/16	17	100	78	55.1	10	25.5	12	6	7	20.5	62	28.3	31	12.7	M10	3/8	UCFX203-11	FC203	0.68	
UCFC204-12	3/1	20	100	78	55.1	10	25.5	12	6	7	20.5	62	28.3	31	12.7	M10	3/8	UCFC204-12	FC204	0.66	
UCFX204		20	100	78	55.1	10	25.5	12	6	7	20.5	62	28.3	31	12.7	M10	3/8	UCFX204	FC204	0.66	
UCFC205-14	7/8	25	115	90	63.6	10	27	12	6	7	21	70	29.7	34.1	14.3	M10	3/8	UCFC205-14	FC205	0.92	
UCFX205-15	15/16	25	115	90	63.6	10	27	12	6	7	21	70	29.7	34.1	14.3	M10	3/8	UCFX205-15	FC205	0.92	
UCFX205		25	115	90	63.6	10	27	12	6	7	21	70	29.7	34.1	14.3	M10	3/8	UCFX205	FC205	0.92	
UCFX205-16	1	25	115	90	63.6	10	27	12	6	7	21	70	29.7	34.1	14.3	M10	3/8	UCFX205-16	FC205	0.92	
UCFC206-18	1 1/8	30	125	100	70.7	10	31	12	8	8	23	80	32.2	38.1	15.9	M10	3/8	UCFC206-18	FC206	1.21	
UCFX206		30	125	100	70.7	10	31	12	8	8	23	80	32.2	38.1	15.9	M10	3/8	UCFX206	FC206	1.21	
UCFX206-19	1 3/16	30	125	100	70.7	10	31	12	8	8	23	80	32.2	38.1	15.9	M10	3/8	UCFX206-19	FC206	1.21	
UCFX206-20	1 1/4	30	125	100	70.7	10	31	12	8	8	23	80	32.2	38.1	15.9	M10	3/8	UCFX206-20	FC206	1.21	
UCFC207-20	1 1/4	35	135	110	77.8	11	34	14	8	9	26	90	36.4	42.9	17.5	M12	7/16	UCFC207-20	FC207	1.5	
UCFX207-21	1 5/16	35	135	110	77.8	11	34	14	8	9	26	90	36.4	42.9	17.5	M12	7/16	UCFX207-21	FC207	1.5	
UCFX207-22	1 3/8	35	135	110	77.8	11	34	14	8	9	26	90	36.4	42.9	17.5	M12	7/16	UCFX207-22	FC207	1.5	
UCFX207		35	135	110	77.8	11	34	14	8	9	26	90	36.4	42.9	17.5	M12	7/16	UCFX207	FC207	1.5	
UCFX207-23	1 7/16	35	135	110	77.8	11	34	14	8	9	26	90	36.4	42.9	17.5	M12	7/16	UCFX207-23	FC207	1.5	
UCFC208-24	1 1/2	40	145	120	84.8	11	36	14	10	9	26	100	41.2	49.2	19	M12	7/16	UCFC208-24	FC208	1.87	
UCFX208-25	1 9/16	40	145	120	84.8	11	36	14	10	9	26	100	41.2	49.2	19	M12	7/16	UCFX208-25	FC208	1.87	
UCFX208		40	145	120	84.8	11	36	14	10	9	26	100	41.2	49.2	19	M12	7/16	UCFX208	FC208	1.87	
UCFC209-26	1 5/8	45	160	132	93.3	10	38	16	12	14	26	105	40.2	49.2	19	M14	1/2	UCFC209-26	FC209	2.34	
UCFX209-27	1 11/16	45	160	132	93.3	10	38	16	12	14	26	105	40.2	49.2	19	M14	1/2	UCFX209-27	FC209	2.34	
UCFX209-28	1 3/4	45	160	132	93.3	10	38	16	12	14	26	105	40.2	49.2	19	M14	1/2	UCFX209-28	FC209	2.34	
UCFX209		45	160	132	93.3	10	38	16	12	14	26	105	40.2	49.2	19	M14	1/2	UCFX209	FC209	2.34	
UCFC210-30	1 7/8	50	165	138	97.6	10	40	16	12	14	28	110	42.6	51.6	19	M14	1/2	UCFC210-30	FC210	2.72	
UCFX210-31	1 15/16	50	165	138	97.6	10	40	16	12	14	28	110	42.6	51.6	19	M14	1/2	UCFX210-31	FC210	2.72	