

# SER 系列

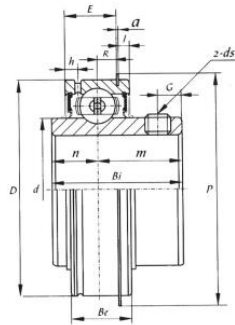

SER 200 (normal-duty)



select	Inquiry	轴承 型号	轴径		尺寸(mm)													基本额定 载荷(N)		重 量(g)
			in	mm	D	Bi	Be	n	m	E	a	h	R	J	P	G	ds	Cr	Cor	
SER201		12	47	31	15.9	11.5	19.5	12.09	1.07	4	4.14	2.46	52.7	5	M6X1.0	1010	630	0.22		
SER201-8	1/2	12	47	31	15.9	11.5	19.5	12.09	1.07	4	4.14	2.46	52.7	5	M6X1.0	1010	630	0.22		
SER202		15	47	31	15.9	11.5	19.5	12.09	1.07	4	4.14	2.46	52.7	5	M6X1.0	1010	630	0.22		
SER202-10	5/8	15	47	31	15.9	11.5	19.5	12.09	1.07	4	4.14	2.46	52.7	5	M6X1.0	1010	630	0.22		
SER203		17	47	31	15.9	11.5	19.5	12.09	1.07	4	4.14	2.46	52.7	5	M6X1.0	1010	630	0.22		
SER203-11	11/16	17	47	31	15.9	11.5	19.5	12.09	1.07	4	4.14	2.46	52.7	5	M6X1.0	1010	630	0.22		
SER204-12	3/4	20	47	31	15.9	11.5	19.5	12.09	1.07	4	4.14	2.46	52.7	5	M6X1.0	1010	630	0.21		
SER204		20	47	31	15.9	11.5	19.5	12.09	1.07	4	4.14	2.46	52.7	5	M6X1.0	1010	630	0.21		
SER205-14	7/8	25	52	34.9	19.1	13.1	21.8	15.29	1.07	5.2	5.74	2.46	52.7	5	M6X1.0	1010	630	0.21		
SER205-15	15/16	25	52	34.9	19.1	13.1	21.8	15.29	1.07	5.2	5.74	2.46	52.7	5	M6X1.0	1010	630	0.21		
SER205		25	52	34.9	19.1	13.1	21.8	15.29	1.07	5.2	5.74	2.46	57.9	5.6	M6X1.0	1100	710	0.27		
SER205-16	1	25	52	34.9	19.1	13.1	21.8	15.29	1.07	5.2	5.74	2.46	57.9	5.6	M6X1.0	1100	710	0.27		
SER206-1	1 1/8	30	62	38.1	22.2	15.9	22.2	17.02	1.65	5.6	5.92	3.28	67.7	5.6	M6X1.0	1530	1020	0.39		
SER206		30	62	38.1	22.2	15.9	22.2	17.02	1.65	5.6	5.92	3.28	67.7	5.6	M6X1.0	1530	1020	0.39		
SER206-19	1 3/16	30	62	38.1	22.2	15.9	22.2	17.02	1.65	5.6	5.92	3.28	67.7	5.6	M6X1.0	1530	1020	0.39		
SER206-20	1 1/4	30	62	38.1	22.2	15.9	22.2	17.02	1.65	5.6	5.92	3.28	67.7	5.6	M6X1.0	1530	1020	0.39		
SER207-20	1 1/4	35	72	42.9	23.8	17.5	25.4	18.62	1.65	5.6	6.72	3.28	78.6	6.4	M8X1.0	2020	1390	0.56		
SER207-22	1 3/8	35	72	42.9	23.8	17.5	25.4	18.62	1.65	5.6	6.72	3.28	78.6	6.4	M8X1.0	2020	1390	0.56		
SER207		35	72	42.9	23.8	17.5	25.4	18.62	1.65	5.6	6.72	3.28	78.6	6.4	M8X1.0	2020	1390	0.56		
SER207-23	1 7/16	35	72	42.9	23.8	17.5	25.4	18.62	1.65	5.6	6.72	3.28	78.6	6.4	M8X1.0	2020	1390	0.56		
SER208-24	1 1/2	40	80	49.2	27.8	19	30.2	22.62	1.65	6.4	8.72	3.28	86.6	8	M8X1.0	2280	1590	0.72		
SER208		40	80	49.2	27.8	19	30.2	22.62	1.65	6.4	8.72	3.28	86.6	8	M8X1.0	2280	1590	0.72		
SER209-26	1 5/8	45	85	49.2	27.8	19	30.2	22.62	1.65	6.4	8.72	3.28	91.6	8	M8X1.0	2560	1810	0.9		
SER209-27	1 11/16	45	85	49.2	27.8	19	30.2	22.62	1.65	6.4	8.72	3.28	91.6	8	M8X1.0	2560	1810	0.9		
SER209-28	1 3/4	45	85	49.2	27.8	19	30.2	22.62	1.65	6.4	8.72	3.28	91.6	8	M8X1.0	2560	1810	0.9		

## SER 系列

SER209		45	85	49.2	27.8	19	30.2	22.62	1.65	6.4	8.72	3.28	91.6	8	M8X1.0	2560	1810	0.9
SER210-30	1 7/8	50	90	51.6	28.6	19	32.6	22.62	2.41	7.5	8.32	3.28	96.5	9.5	M10X1.0	2750	2020	0.93
SER210-31	1 15/16	50	90	51.6	28.6	19	32.6	22.62	2.41	7.5	8.32	3.28	96.5	9.5	M10X1.0	2750	2020	0.93
SER210		50	90	51.6	28.6	19	32.6	22.62	2.41	7.5	8.32	3.28	96.5	9.5	M10X1.0	2750	2020	0.93
SER 210-32	2	50	90	51.6	28.6	19	32.6	22.62	2.41	7.5	8.32	3.28	96.5	9.5	M10X1.0	2750	2020	0.93