

UC200 系列

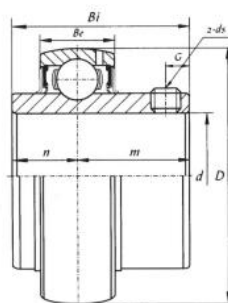

UC 200 (normal-duty)



select	Inquiry	轴承 型号	轴径		尺寸(mm)								基本额定 载荷(N)		重量 (g)
			in	mm	D	Bi	Be	n	m	G	ds	Cr	Cor		
UC201		12	47	31	16	12.7	18.3	5	M6x1.0	12800	6650	0.2			
UC201-8	1/2	12	47	31	16	12.7	18.3	5	M6x1.0	12800	6650	0.19			
UC202		15	47	31	16	12.7	18.3	5	M6x1.0	12800	6650	0.18			
UC 202-10	5/8	15	47	31	16	12.7	18.3	5	M6x1.0	12800	6650	0.18			
UC203		17	47	31	16	12.7	18.3	5	M6x1.0	12800	6650	0.17			
UC203-11	11/16	17	47	31	16	12.7	18.3	5	M6x1.0	12800	6650	0.17			
UC204-12	3/4	20	47	31	16	12.7	18.3	5	M6x1.0	12800	6650	0.16			
UC204		20	47	31	16	12.7	18.3	5	M6x1.0	12800	6650	0.15			
UC205-14	7/8	25	52	34.1	17	14.3	19.8	5.5	M6x1.0	14000	7880	0.22			
UC205-15	15/16	25	52	34.1	17	14.3	19.8	5.5	M6x1.0	14000	7880	0.2			
UC205		25	52	34.1	17	14.3	19.8	5.5	M6x1.0	14000	7880	0.19			
UC205-16	1	25	52	34.1	17	14.3	19.8	5.5	M6x1.0	14000	7880	0.19			
UC206-18	1 1/8	30	62	38.1	19	15.9	22.2	6	M6x1.0	14500	11200	0.32			
UC206		30	62	38.1	19	15.9	22.2	6	M6x1.0	14500	11200	0.3			
UC206-19	1 3/16	30	62	38.1	19	15.9	22.2	6	M6x1.0	14500	11200	0.3			
UC206-20	1 1/4	30	62	38.1	19	15.9	22.2	6	M6x1.0	14500	11200	0.3			
UC207-20	1 1/4	35	72	42.9	20	17.5	25.4	6.5	M8x1.0	25700	15200	0.5			
UC207-21	1 5/16	35	72	42.9	20	17.5	25.4	6.5	M8x1.0	25700	15200	0.48			
UC207-22	1 3/8	35	72	42.9	20	17.5	25.4	6.5	M8x1.0	25700	15200	0.45			
UC207		35	72	42.9	20	17.5	25.4	6.5	M8x1.0	25700	15200	0.45			

UC200 系列

UC207-23	$\frac{1}{7/16}$	35	72	42.9	20	17.5	25.4	6.5	M8x1.0	25700	15200	0.42
UC208-24	1 1/2	40	80	49.2	21	19	30.2	8	M8x1.0	29600	18200	0.64
UC208-25	$\frac{1}{9/16}$	40	80	49.2	21	19	30.2	8	M8x1.0	29600	18200	0.6
UC208		40	80	49.2	21	19	30.2	8	M8x1.0	29600	18200	0.59
UC209-26	1 5/8	45	85	49.2	22	19	30.2	8	M8x1.0	31850	20800	0.74
UC209-27	$\frac{1}{11/16}$	45	85	49.2	22	19	30.2	8	M8x1.0	31850	20800	0.71
UC209-28	1 3/4	45	85	49.2	22	19	30.2	8	M8x1.0	31850	20800	0.68
UC209		45	85	49.2	22	19	30.2	8	M8x1.0	31850	20800	0.65
UC210-30	1 7/8	50	90	51.6	23	19	32.6	10	M10x1.0	35100	23200	0.85
UC210-31	$\frac{1}{15/16}$	50	90	51.6	23	19	32.6	10	M10x1.0	35100	23200	0.76